

# Time is money!

Thanks to the advance of modern communication technology, modern plants are populated with devices that can spill huge amount of data. However how much of this data is turned into useful information, is still an interesting challenge.



Advanced Industrial Automation



Omron has developed a new concept called: 'Smart Active Parts'. This enables engineers to turn all of the information available in modern machines, into a useful Human Machine Interface in just four simple steps.

### Conventional HMI programming

As the HMI evolves into a complete Machine Management Tools, there is an ever-increasing need for engineers to master all of the devices in a machine.

To design a comprehensive HMI, which enables operators to configure, commission, operate and maintain a machine, engineers need to:

- Program the HMI to manage a device
- Program the communication to the device
- Program the PLC to arrange the data from the device
- Test the communication
- Test the PLC program
- Test the HMI program

Of course all of this programming and testing consists of many separate steps and takes designers a lot of time to complete.

### Four steps solution: Click and Configure

The way Omron saves designers a lot of time, is with the help of Smart Active Parts and Smart Field Devices. In just four simple steps you can create a complete device management screen:

1. Create a new project
2. Open the Smart Active Parts Library
3. Choose a Smart Active Part
4. Configure the communication settings

Smart Active Parts are provided, free of charge, in the development package for Omron's NS-series HMI, NS-Designer.

Conventional design of a HMI application required the developer to master PLC programming, HMI programming and device communication.

**With Smart Active Parts none of that is needed!**

## So what are Smart Active Parts?

Smart Active Parts are pre-programmed, pre-tested visualization objects with embedded communication code, bringing 'drag and drop' simplicity to HMI design.

Written and tested by Omron's control experts, these visualization objects are called Smart and Active because they automate the communication with the Omron Smart Field Devices. Unlike conventional visualization objects, Smart Active Parts automatically communicate, when needed across multiple networks, with their corresponding devices. They can be used to configure, commission, operate and maintain these devices, without a single line of code needing to be written in the PLC or the HMI. Dramatically reducing development and debugging time!

## So what about the Smart Field Devices

Omron offers a vast range of Smart Field Devices (e.g. Temperature Controllers, Inverters, Sensors). There are over 1000 Smart Active Parts available, multiple per device to configure, commission, operate or maintain them.

These devices are called Smart, because they are self-maintaining. The Smart Field Devices are constantly monitoring key parameters and when needed reporting this, by the built-in communication, to the HMI. This happens without the need for the HMI or PLC to be in charge of checking each device. This reduces both the load on the network and the control burden on the PLC and HMI, so improving the overall speed and response of the control architecture of the machine.

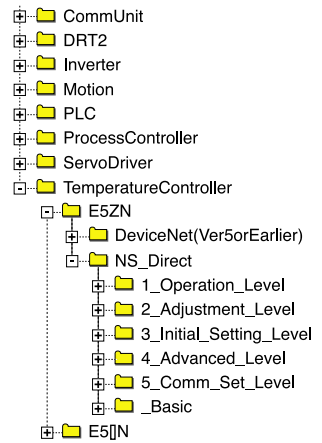

The library already consists of Smart Active Parts for almost all Omron devices and is growing every month.

Would you like to see how much time you can save with Smart Active Parts?

Go to <http://ns.europe.omron.com> and watch the demo.

## From Programming...

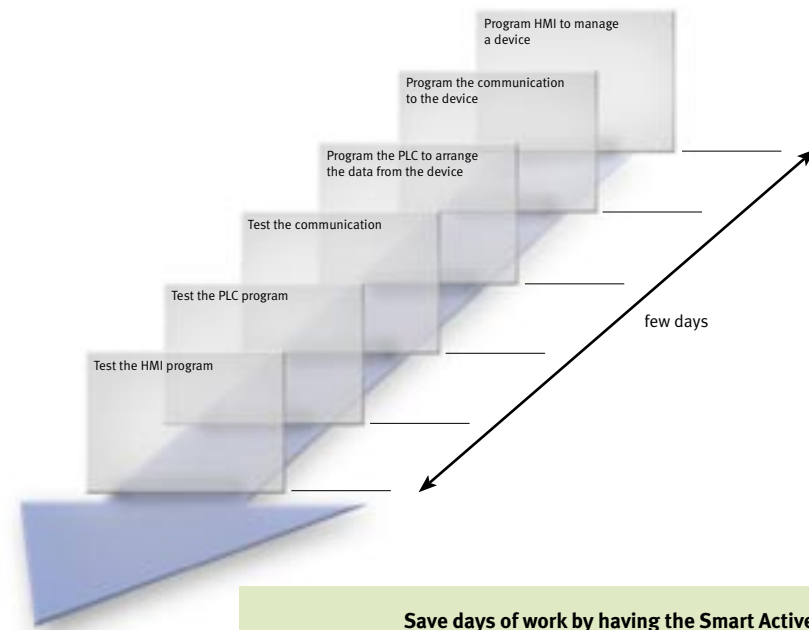

## ...to Click and Configure in four steps.

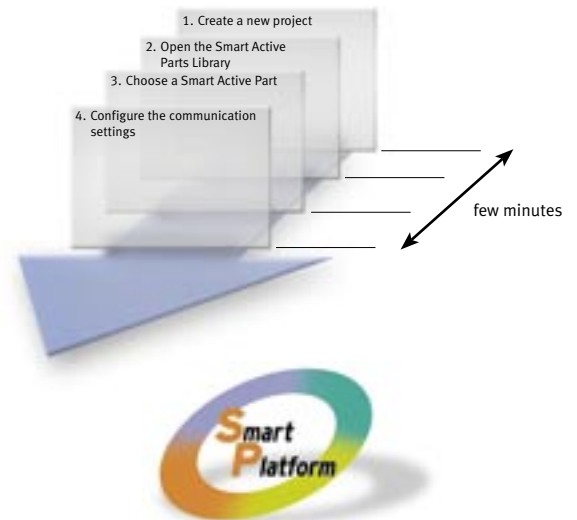

Save days of work by having the Smart Active Parts work for you!

**OMRON EUROPE B.V.** Wegalaan 67-69, NL-2132 JD, Hoofddorp, The Netherlands. Tel: +31 (0) 23 568 13 00 Fax: +31 (0) 23 568 13 88 [www.europe.omron.com](http://www.europe.omron.com)

**Austria**  
Tel: +43 (0) 1 80 19 00  
[www.omron.at](http://www.omron.at)

**Belgium**  
Tel: +32 (0) 2 466 24 80  
[www.omron.be](http://www.omron.be)

**Czech Republic**  
Tel: +420 234 602 602  
[www.omron.cz](http://www.omron.cz)

**Denmark**  
Tel: +45 43 44 00 11  
[www.omron.dk](http://www.omron.dk)

**Finland**  
Tel: +358 (0) 9 549 58 00  
[www.omron.fi](http://www.omron.fi)

**France**  
Tel: +33 (0) 1 56 63 70 00  
[www.omron.fr](http://www.omron.fr)

**Germany**  
Tel: +49 (0) 2173 680 00  
[www.omron.de](http://www.omron.de)

**Hungary**  
Tel: +36 (0) 1 399 30 50  
[www.omron.hu](http://www.omron.hu)

**Italy**  
Tel: +39 02 32 681  
[www.omron.it](http://www.omron.it)

**Netherlands**  
Tel: +31 (0) 23 568 11 00  
[www.omron.nl](http://www.omron.nl)

**Norway**  
Tel: +47 (0) 22 65 75 00  
[www.omron.no](http://www.omron.no)

**Poland**  
Tel: +48 (0) 22 645 78 60  
[www.omron.com.pl](http://www.omron.com.pl)

**Portugal**  
Tel: +351 21 942 94 00  
[www.omron.pt](http://www.omron.pt)

**Russia**  
Tel: +7 095 745 26 64  
[www.omron.ru](http://www.omron.ru)

**Spain**  
Tel: +34 913 777 900  
[www.omron.es](http://www.omron.es)

**Sweden**  
Tel: +46 (0) 8 632 35 00  
[www.omron.se](http://www.omron.se)

**Switzerland**  
Tel: +41 (0) 41 748 13 13  
[www.omron.ch](http://www.omron.ch)

**Turkey**  
Tel: +90 (0) 216 474 00 40  
[www.omron.com.tr](http://www.omron.com.tr)

**United Kingdom**  
Tel: +44 (0) 870 752 08 61  
[www.omron.co.uk](http://www.omron.co.uk)

For the Middle East, Africa and other countries in Eastern Europe, Tel: +31 (0) 23 568 13 00 [www.europe.omron.com](http://www.europe.omron.com)

Although we strive for perfection, Omron Europe BV and/or its subsidiary and affiliated companies do not warrant or make any representations regarding the correctness or completeness of the information contained herein. We reserve the right to make any changes at any time without prior notice.  
SF2P\_Smart Active Parts\_EN\_INT01\_0405

**OMRON**